

We T.H.Jensen Bowers Pty. Ltd., Cadastral Surveyors, hereby certify that the "As Constructed" information contained in this drawing is accurate. We accept responsibility for, and acknowledge that the "As Constructed" information may be relied on by Council and Others.

Director

The as constructed assets shown hereon have been located and plotted for horizontal and vertical position only. Whilst due care and attention has been exercised, T.H.Jensen Bowers Pty Ltd does not take responsibility for other attributes. These should be confirmed by the project engineer.

LEGEND

- ∅ Pipe Diameter
- Fire Hydrant
- Ready Tap
- Bend
- ⋈ Valve
- ⊠ Water Meter
- c- Water Crossing
- T T Junction
- R Reducer

NOTES

- All water main pipes are uPVC Class 16 unless otherwise stated
- All water service pipes are Q25 PE-100 Class PN16
- All water conduit pipes are Ø100 uPVC Class 20

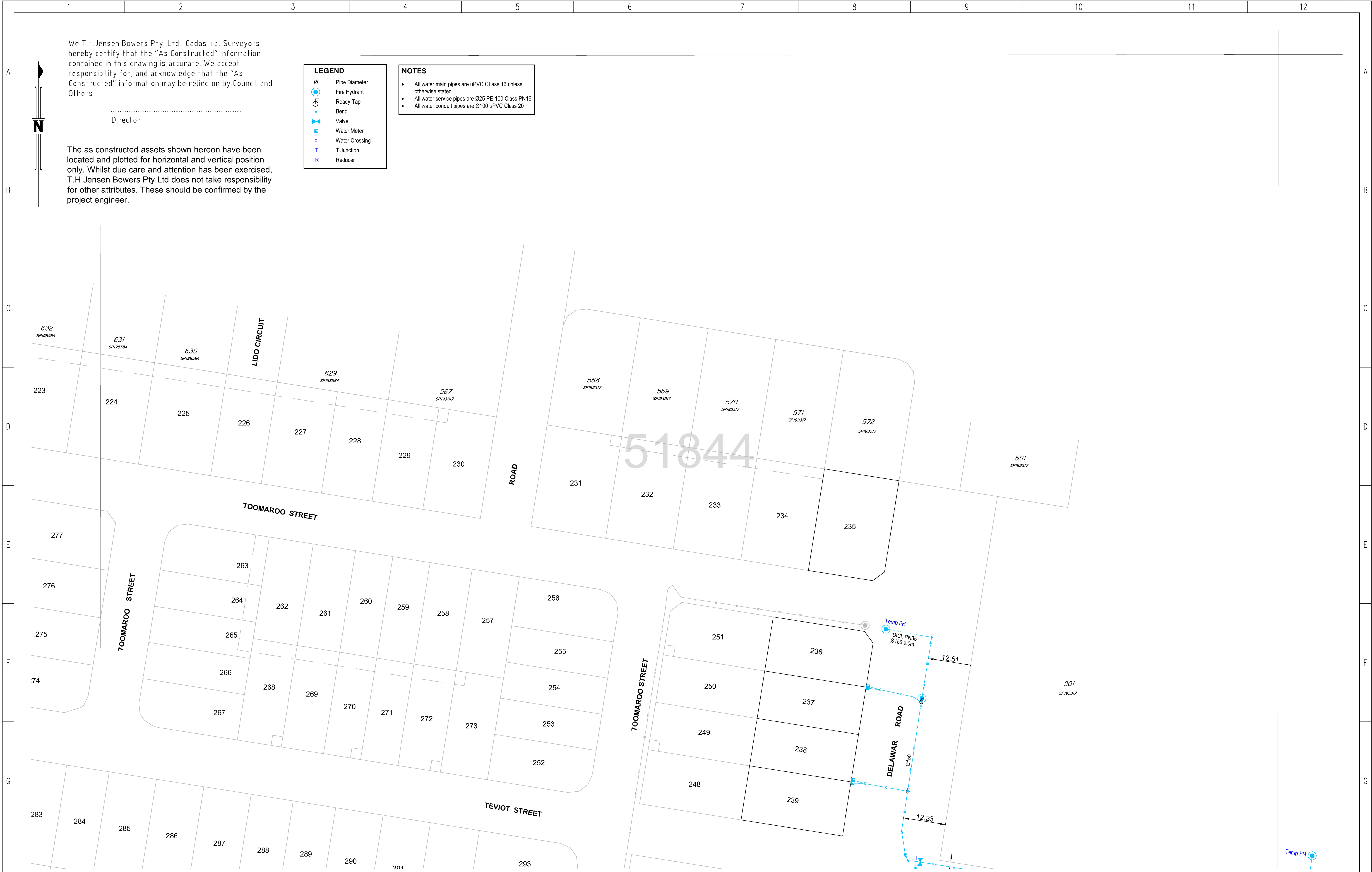

DRAWING REVISIONS		REFERENCE DRAWINGS		DESIGN FILE No.	DESIGNED
REV.	REVISION DESCRIPTION	DRG. No.	DESCRIPTION	CONSTRUCT. No.	DATE
				SURVEY FILE No. S-7433-436	DRAWN JM
				FIELD BOOK	DATE 21/01/16
				LOG BOOK	CHECKED WG
				LEVEL DATUM PMS7810 (RL47.358m)	DATE
				DATUM MGA Zone 56	

THIS WORK WAS PREPARED BY:
DEFENCE HOUSING AUSTRALIA

SCALE 1:500 ORIGINAL SIZE A1



MORETON BAY REGIONAL COUNCIL
 CABOOLTURE DISTRICT OFFICE
 2 HASKING STREET CABOOLTURE QLD 4510
 PO BOX 159 CABOOLTURE QLD 4510
 Telephone: (07) 5433 0100
 Fax: (07) 5433 4000

WARNER SPRINGS ESTATE
 Kremzow Road, Warner
 Stage 5B
 'AS CONSTRUCTED' - WATER

MBRC SUBDIVISION REFERENCE	
DA/20033/2008/N4DU/8	
No. 1 OF 2 PLANS	
ASCAN GRID NUMBER	REV.
51844	



NOTES

- All water main pipes are uPVC Class 16 unless otherwise stated
- All water service pipes are Ø25 PE-100 Class PN16
- All water conduit pipes are Ø100 uPVC Class 20

LEGEND

Ø	Pipe Diameter
⊙	Fire Hydrant
⊕	Ready Tap
⋄	Bend
⊕	Valve
⊕	Water Meter
-c-	Water Crossing
T	T Junction
R	Reducer

We T.H.Jensen Bowers Pty. Ltd., Cadastral Surveyors, hereby certify that the "As Constructed" information contained in this drawing is accurate. We accept responsibility for, and acknowledge that the "As Constructed" information may be relied on by Council and Others.

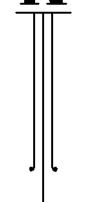

Director

The as constructed assets shown hereon have been located and plotted for horizontal and vertical position only. Whilst due care and attention has been exercised, T.H.Jensen Bowers Pty Ltd does not take responsibility for other attributes. These should be confirmed by the project engineer.

DRAWING REVISIONS		REFERENCE DRAWINGS		DESIGN FILE No.	DESIGNED	<p>THIS WORK WAS PREPARED BY: DEFENCE HOUSING AUSTRALIA</p> <p>SCALE 1:500 ORIGINAL SIZE A1</p>	<p>MORETON BAY REGIONAL COUNCIL CABOOLTURE DISTRICT OFFICE 2 HASKING STREET CABOOLTURE QLD 4510 PO BOX 159 CABOOLTURE QLD 4510 Telephone: (07) 5433 0100 Fax: (07) 5433 4000</p>	<p>WARNER SPRINGS ESTATE Kremzow Road, Warner Stage 5B</p> <p>'AS CONSTRUCTED' - WATER</p>		MBC SUBDIVISION REFERENCE	
REV.	REVISION DESCRIPTION	DRG. No.	DESCRIPTION	CONSTRUCT. No.	DATE					DA/20033/2008/N4DU/8	
				SURVEY FILE No. S-7433-436	DRAWN JM					No. 2 OF 2 PLANS	
				FIELD BOOK	DATE 21/01/16					ASCEN GRID NUMBER	
				LOG BOOK	CHECKED WG					REV.	
				LEVEL DATUM PMS7810 (RL47.358m)	DATE					52011	
				DATUM MGA Zone 56							